



a xylem brand

WE KNOW™
D.O.

Installation manual

SET/AP



Cleaning set for 701 IQ and 705 IQ series UV/VIS sensors



a xylem brand

WE KNOW™
D.O.

Installation manual

SET/AP

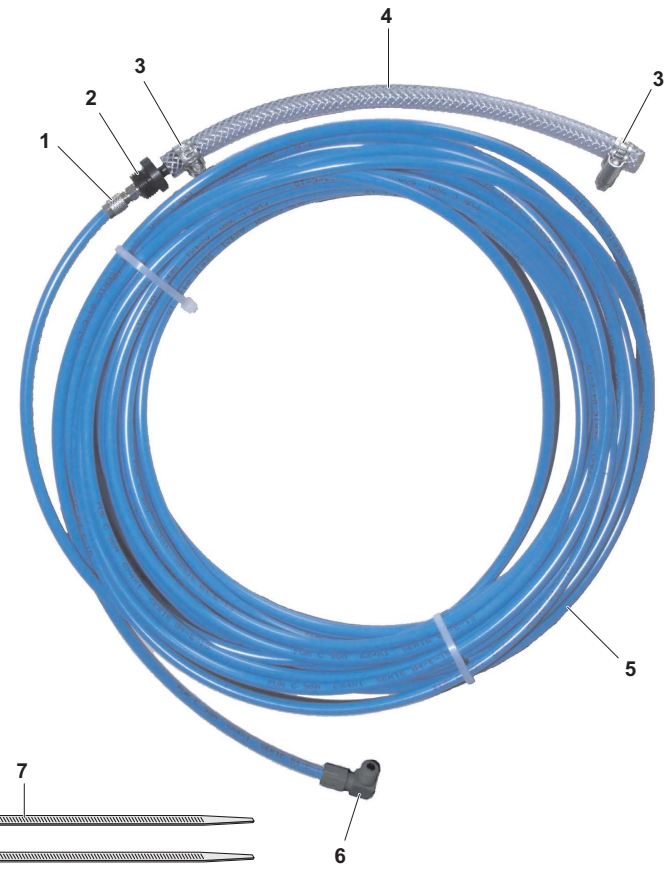

Cleaning set for 701 IQ and 705 IQ series UV/VIS sensors

Installation

Requirements to te compressed air

Air quality	Dry, free of dust and oil
Operating pressure	Max. 7×10^5 Pa (7 bar) absolute
Flow	25 NL/min. (standard liters/minute)

Mounting the compressed air hose on the sensor

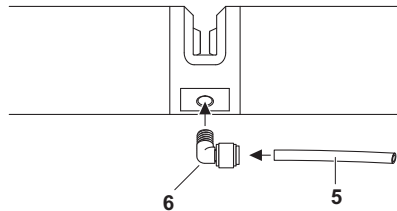

- 1 Screw-in the elbow joint (6) as shown in the figure.
- 2 Insert the thin end of the compressed air hose (5) in the elbow joint.
- 3 Run the compressed air hose to the MIQ/CHV and cut it off at a suitable length as necessary. To prevent foreign bodies from getting caught, use cable ties to attach the hose to the sensor shaft.
- 4 Connect the other end of the compressed air hose to the compressed air source. Secure the connection with a hose clip.

List of materials

Pos.	Description	Material
1	Screwed connection	Nickel-plated brass
2	Adaptor	POM
3	Hose clamp	V4A stainless steel
4	Fabric-reinforced compressed air hose	PVC
5	Compressed air hose	PU
6	Elbow joint	POM
/	Cable tie (2x)	PA

Installation

Requirements to te compressed air

Air quality	Dry, free of dust and oil
Operating pressure	Max. 7×10^5 Pa (7 bar) absolute
Flow	25 NL/min. (standard liters/minute)

Mounting the compressed air hose on the sensor

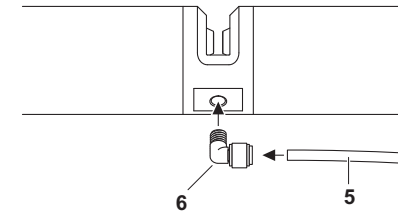

- 1 Screw-in the elbow joint (6) as shown in the figure.
- 2 Insert the thin end of the compressed air hose (5) in the elbow joint.
- 3 Run the compressed air hose to the MIQ/CHV and cut it off at a suitable length as necessary. To prevent foreign bodies from getting caught, use cable ties to attach the hose to the sensor shaft.
- 4 Connect the other end of the compressed air hose to the compressed air source. Secure the connection with a hose clip.

List of materials

Pos.	Description	Material
1	Screwed connection	Nickel-plated brass
2	Adaptor	POM
3	Hose clamp	V4A stainless steel
4	Fabric-reinforced compressed air hose	PVC
5	Compressed air hose	PU
6	Elbow joint	POM
/	Cable tie (2x)	PA